

SG HOLDINGS CO., LTD.

68 Kamitobatsunoda-cho, Minami-ku, Kyoto-shi, Kyoto, 601-8104 Japan
Tel: 075-671-8600

<https://www.sg-hldgs.co.jp/en/>

SG Holdings Co., Ltd. | Corporate profile



Grow the new Story.
New logistics, nurturing a new society together.

Top Message

Grow the new Story.

New logistics, nurturing a new society together.

Eiichi Kuriwada
Chairperson and CEO
SG Holdings Co., Ltd.

栗和田 栄一



Hidekazu Matsumoto
President and COO
SG Holdings Co., Ltd.

松本 秀一



The SG Holdings Group is a comprehensive logistics group that meets all logistics needs of customers, from upstream to downstream. Since the Group was founded in 1957, we have conducted logistics business while inheriting the “hikyaku no kokoro” (the spirit of Edo-era express messengers) of constantly thinking about what we can do for customers and acting with the best of intentions. We are also continuing to embrace the challenge of providing new logistics value to customers based on the corporate philosophy of “Trust, Create, Challenge.”

In recent years, in addition to the shrinking workforce caused by the declining birthrate and aging population that has been an issue for some time, the social environment surrounding us has undergone change at a dramatic pace never seen before, such as efforts aimed at the government’s goal to make Japan carbon neutral by 2050, advances in AI and IoT technology, and the promotion of DX. Furthermore, we have also seen a transition to an era that could not be predicted by anyone, due to factors such as the spread of COVID-19.

In order to respond to this rapidly changing social environment, we established a long-term vision of “Grow the new Story. New logistics, nurturing a new society together.” aimed at 2030. This vision is based on the intent to combine the strengths of customers, diverse

partners and colleagues to transform logistics with the aim of creating value that will lead us into the future.

The Mid-term Management Plan “SGH Story 2024” which was formulated to achieve this long-term vision is based on the basic policy of “creating a next-generation competitive advantage to realize sustainable growth,” and we are engaging in “advancement of comprehensive logistics solutions,” “expansion of management resources to create a competitive advantage,” and “further advancement of governance.”

The strength of the SG Holdings Group is the ability to gather information through Sales Drivers®, which are our contact with customers. In addition, we have the comprehensive ability to meet all of the needs of customers by utilizing a variety of resources such as delivery, logistics, real estate, IT and vehicle maintenance. We will fully utilize this strength to provide logistics services that are valuable for society and customers, and sincerely engage in business activities going forward to continue to grow with you.

Looking ahead, we will use the “hikyaku no kokoro” as a source of strength as we aim to become a corporate group trusted by all stakeholders by providing optimal solutions adapted to the times. We appreciate your unwavering support.

Our Corporate Philosophy and Guiding Principles

Ethical principles guiding the behavior of each and every employee.

Consistent ethical behavior builds trust with customers and shapes the SG Holdings Group.

Corporate Philosophy

“Trust, Create, Challenge”

SG Holdings Group will:

- Earn the trust of customers and society and grow together;
- Create new value, contributing to social development;
- Always take on the challenges presented to us, pursuing all possibilities.

The Corporate Philosophy has been renewed while preserving the cornerstone of the company’s foundation, “Hikyaku no Kokoro” (the spirit of Edo-era express messengers). Our philosophy embodies the spirit of evolution and innovation towards a better future.

Charter of Corporate Conduct

In tandem with the Corporate Philosophy, the charter declares that legal compliance based on ethical principles is an essential part of fulfilling social responsibility.

Code of Ethics and Conduct

The code specifies the conduct that all officers and employees adhere to in order to fulfill the spirit of the Charter of Corporate Conduct.

SG Holdings Group **SGH Vision 2030**

Grow the new Story.

New logistics, nurturing a new society together.

For the creation of logistics that continue to be required by society

The SG Holdings Group established “Grow the new Story: New logistics, nurturing a new society together” as its long-term vision. The Group will focus on significantly growing comprehensive logistics solutions such as TMS, 3PL and global and overseas business while aiming to stably expand the Group’s core business in express package delivery services. We will also actively promote initiatives aimed at the resolution of social and environmental issues such as decarbonization.

With the aim of realizing a sustainable society, we will continue to follow a new growth story creating new value through the creation of new logistics leading to the future with all stakeholders.

Grow

This reflects our desire to grow and develop a new society and story together with our partners through the power of logistics. We will seek to create innovation and create next-generation competitive advantages in an open environment with a variety of companies and employees including not only those in the Group but also our customers.

Story

Through solutions provided by the Group, we wish to contribute to a new society (a sustainable society) and set out on a new growth story. The “S” that is the first letter represents our desire for the Group as a whole to engage in all the important themes including **SGH, SAGAWA, Solution, Social, Smart, Share** and **Sustainable**.

Solution



Social



Smart



Share



Sustainable





Value provided to customers and society
Support for the creation of sustainable and dynamic supply chains and value chains

Mid-term Management Plan
「SGH Story 2024」

Basic Policy

Creation of next-generation competitive advantages to realize sustainable growth

One-stop Solutions Covering All Business Fields

We optimize customer logistics by providing integrated solutions extending from the upstream to downstream business fields, from procurement outside Japan and logistics processes to last-mile delivery to consumers.

Overseas



EXPOLANKA HOLDINGS

Overseas

- International air transportation
- International ocean transportation



SGH GLOBAL JAPAN

Overseas

- International air transportation
- International ocean transportation
- Local express package delivery services
- In-warehouse processing

Import and export

- Customs clearing
- Bonded warehouse



CHILLED & FROZEN LOGISTICS HOLDINGS

Frozen logistics

- Storage of frozen food
- Joint delivery

Refrigerated logistics

- Management of distribution centers for refrigerated beverages and food products, joint delivery



SG MOTORS

Vehicles

- Sales
- Maintenance
- Truck body manufacturing



SAGAWA GLOBAL LOGISTICS

In-warehouse

- Storage and processing work
- Inspection and needle detection work
- Assorting
- E-commerce support
- Handling returns
- Inventory management



SG FIELDER

Temporary staffing service

- Temporary staffing/referral of human resources
- Outsourcing services



SG MOVING

Special transportation

- Office and factory relocation
- Transportation and setting up of furniture/electric appliances/office equipment
- Artwork transportation

Offices, etc.



SG ASSETMAX

Real Estate

- Real estate investment and operation business



SG REALTY

Real estate

- Real estate management
- Real estate operation
- Renewable energy business

WORLD SUPPLY

Commercial facilities

- Centralized management of facility logistics in commercial facilities
- Third-party delivery for department stores and major retail stores
- Cleaning ● Security

Large commercial facilities

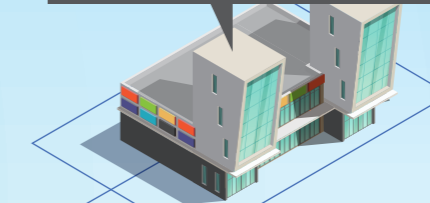

SG SYSTEMS

Financial services

- Settlement services
- Online settlement services
- E-money settlement services

Systems

- System consulting
- System operation and maintenance



SG ADVANCE

Planning and sales services

- Insurance sales
- Fuel sales
- Facility operation
- Planning and sales business for products and travel/event services



SAGAWA HUMONY

Message delivery service

- VERY CARD message delivery service

Logistics center

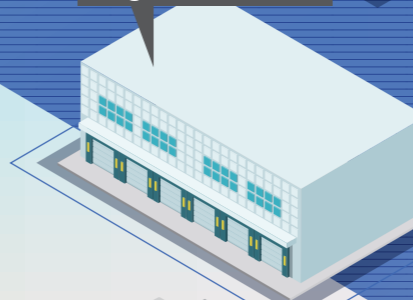

SAGAWA

SAGAWA EXPRESS

Comprehensive logistics solutions

- Express package delivery services
- TMS
- Logistics consulting

Companies

Individuals

Japan



Main services

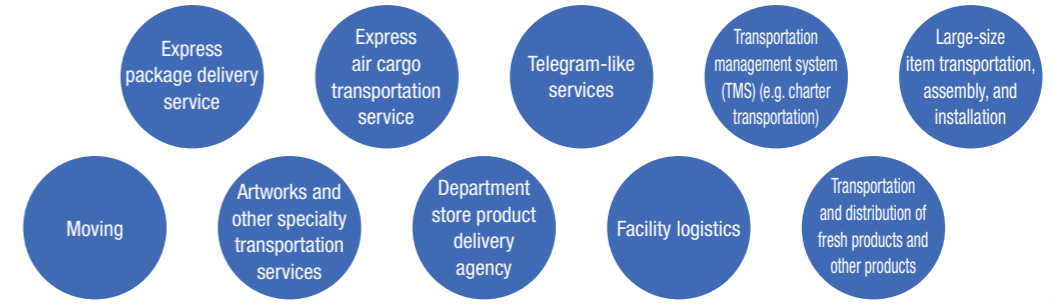

Providing one-stop solutions solving logistics challenges

Delivery business

Providing logistics solutions driven by the core express package delivery business

We offer optimized delivery solutions by leveraging a nationwide transport network in Japan and grasping the diversifying logistics challenges of our customers. This approach allows us to offer not only such basic delivery services as express package delivery, large item delivery, and chilled and frozen international air transportation, but total solutions such as facility logistics and integrated logistics covering sites outside Japan.



Facilitating installation and transport and various other types of moving

We facilitate "transportation plus extra" services primarily for companies, R&D facilities, and educational institutions, which span moving, assembly, equipment installation, and interior construction. Our services expand with the needs of our customers to include specialty transportation for such items as artworks and precision machinery.



Providing third-party delivery to department stores and other high-quality logistics services

We act as the designated transport agent for leading nationwide department stores and large retailers. These services include product shipment, value-added processing, and inventory management, as well as stockyard management support. We maintain a license for the manufacture of cosmetics and quasi-drugs, enabling us to provide such sophisticated services as luxury cosmetics storage and shipment.



Telegram-like services deliver heartfelt thoughts and words for special occasions

We leverage our nationwide delivery network in Japan to timely deliver messages for such ceremonies as weddings, funerals, and personnel appointments. We boast an abundant variety of product designs to meet the many needs of our customers. Our aim is to provide superior telegram-like services with specialized product packaging as well as detailed delivery times.



Group companies

SAGAWA

Sagawa Express Co., Ltd.

Head office: 68 Kamitobatsunoda-cho,
Minami-ku, Kyoto-shi, Kyoto,
Japan
<https://www.sagawa-exp.co.jp/english/>

Sg humony

Sagawa Humony Co., Ltd.

Head office: 2-2-8 Shinsuna, Koto-ku,
Tokyo, Japan
<http://www.humony.co.jp/>

Sg moving

SG Moving Co., Ltd.

Head office: 6F X FRONTIER EAST,
3-2-9 Shinsuna, Koto-ku,
Tokyo, Japan
<https://www.sagawa-mov.co.jp/>

WORLD SUPPLY

World Supply Co., Ltd.

Head office: 1-2-22 Ariake, Koto-ku,
Tokyo, Japan
<https://www.world-supply.co.jp/>

Main services



Optimizing supply chains with integrated services worldwide

Logistics & International Transportation services

Efficient product storage and logistics process support

We optimize the entire logistics operations of our customers by offering services that match their products and business models, from apparel and cosmetics to mail-order products. We provide logistics equipment to meet each customer need, including our proprietary warehouse management system S-WMS, sorters, automated packaging, and RFID systems to raise operational efficiency. With these advantages, we guarantee optimized logistics solutions.



3PL services leveraging Group synergy

As our customers' third-party logistics (3PL) partner, we resolve their management issues by optimizing the entire supply chain, from upstream through downstream functions. Our goal is to help customers reduce lead times by providing one-stop services combining the Group's capabilities, from product warehousing, processing, and other services within the warehouse, to bonded warehouse procedures for import and export.



Cold Chain Also Supporting Food and Pharmaceuticals

We provide a cold chain that ensures safe and secure delivery of chilled and frozen foods that require constant low-temperature management, using facilities such as refrigerated and frozen warehouses and vehicles, as well as our expertise in thorough temperature management. Our high level of technological capabilities enables us to handle products such as pharmaceuticals that require strict temperature control.



High-quality delivery services in local communities around the world

We provide one-stop support for customers' global expansion by combining our local networks in Japan and other countries with our know-how in international logistics. In local communities around the world, the SG Holdings Group provides high-quality, safe, and secure delivery services.



Group companies



Sagawa Global Logistics Co., Ltd.

Location: 1-1-1 Katsushima, Shinagawa-ku, Tokyo, Japan
<https://www.sagawa-logi.com/>



SGH Global Japan Co., Ltd.

Head office: 5F X FRONTIER WEST, 3-2-9 Shinsuna, Koto-ku, Tokyo, Japan
<https://www.sgh-global.jp/english/index.html>



Chilled & Frozen Logistics Holdings Co., Ltd.

Head office: 33-8, Wakamatsu-cho, Shinjuku-ku, Tokyo, Japan
<https://www.cflogi.co.jp/>



Expolanka Holdings Limited

Head office: 15A, Clifford Avenue, Colombo 03, Sri Lanka
<https://www.expolanka.com/>





Changing business with logistics facilities

Real Estate business

Main services

- Real estate management
- Real estate development
- Asset management

Enhancing added and supporting the effective use of real estate

We assist customers in maximizing real estate income and value by optimizing property management and operations. As real estate management professionals, we aim to maximize customer value by providing optimized management services leveraging the operational know-how we have accumulated in operating about 850 delivery and logistics businesses and sites.



Supporting business through logistics sites

We develop real estate properties to optimize the logistics operations essential to our business. These properties include multi-tenant logistics facilities used by a wide range of customers as well as custom-built facilities designed for specific needs. With a long track record of successful development, we offer optimized real estate services to our customers.



Offering investment opportunities featuring logistics facilities

We operate private-subscription REITs and private-subscription investment funds, providing investment opportunities into logistics facilities that act as infrastructure assets connecting living, industry, and society. With a medium- to long-term view, we aim to secure stable income and steadily develop operational assets.



Group companies



SG Realty Co., Ltd.

Head office: 68 Kamitobatsunoda-cho, Minami-ku, Kyoto-shi, Kyoto, Japan
<https://www.sg-realty.co.jp/>



SG Assetmax Co., Ltd.

Head office: 2F Shinsuna SGH Bldg, 1-8-10 Shinsuna, Koto-ku, Tokyo, Japan
<https://www.sg-assetmax.co.jp/>

Logistics Related businesses



Insurance sales

As a casualty insurance agent, we provide a wide range of insurance solutions, from policies covering property custodianship and collection and delivery vehicles, to private car insurance and income security coverage.



Planning and sales

We offer planning and sales services, including original design merchandise, travel products, and event services. We also provide wholesale flower and ornamental plant sales to corporate customers via the Group's logistics network.



Vehicle maintenance / Truck body manufacturing

We conduct vehicle repair, inspection, and maintenance, as well as truck body manufacturing, at 22 vehicle maintenance locations throughout Japan and two truck body manufacturing sites.



IT systems

We provide IT consulting, system design, operation, maintenance, and management services, which leverage our long track record and accumulated know-how in the logistics industry.



Settlement services

We operate a logistics settlement business, highlighted by Sagawa Express's proprietary cash-on-delivery service "e-Collect" and a variety of other financial services.



Temporary staffing

We provide dispatch personnel services and human resources recruitment services mainly to bolster staffing at logistics sites and support about 20,000 regular staff.

Group companies



Sagawa Advance Co., Ltd.

Head office: 4F Shinsuna SGH Bldg., 1-8-10 Shinsuna, Koto-ku, Tokyo, Japan
<https://sg-advance.co.jp/>



SG Motors Co., Ltd.

Head office: 3F Shinsuna SGH Bldg. II, 1-8-2 Shinsuna, Koto-ku, Tokyo, Japan
<https://www.sg-motors.co.jp/>

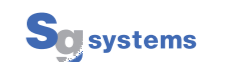

SG Systems Co., Ltd.

Head office: 25 Kamitobatsunoda-cho, Minami-ku, Kyoto-shi, Kyoto, Japan
<https://www.sg-systems.co.jp/>



SG Fielder Co., Ltd.

Head office: 2F JMF-Bldg Toyochō 02, 1-6-35 Shinsuna, Koto-ku, Tokyo, Japan
<https://www.sg-fielder.co.jp/>



Nouvelle Golf Club Co., Ltd.

Head office: 3151-1 Kanaya-gou, Oamishirasato-shi, Chiba, Japan
<https://www.nouvelle-gc.co.jp/>



Sagawa Forestry Co., Ltd.

Head office: 68 Kamitobatsunoda-cho, Minami-ku, Kyoto-shi, Kyoto, Japan
<https://www.sg-hldgs.co.jp/sagawa-fore/>

GOAL Advanced Logistics Project Team

GOAL[®]

(GO Advanced Logistics)

Customized solutions transform logistics into a value chain.

GOAL[®] stands for “GO Advanced Logistics”.

GOAL is our specialized project teams, which work hand-in-hand with customers to solve logistics challenges and achieve a “Goal” using advanced logistics know-how.

Smart Import



Our integrated logistics service delivers products from overseas factories to end-consumers in Japan, optimizing logistics costs, and shortening lead times.

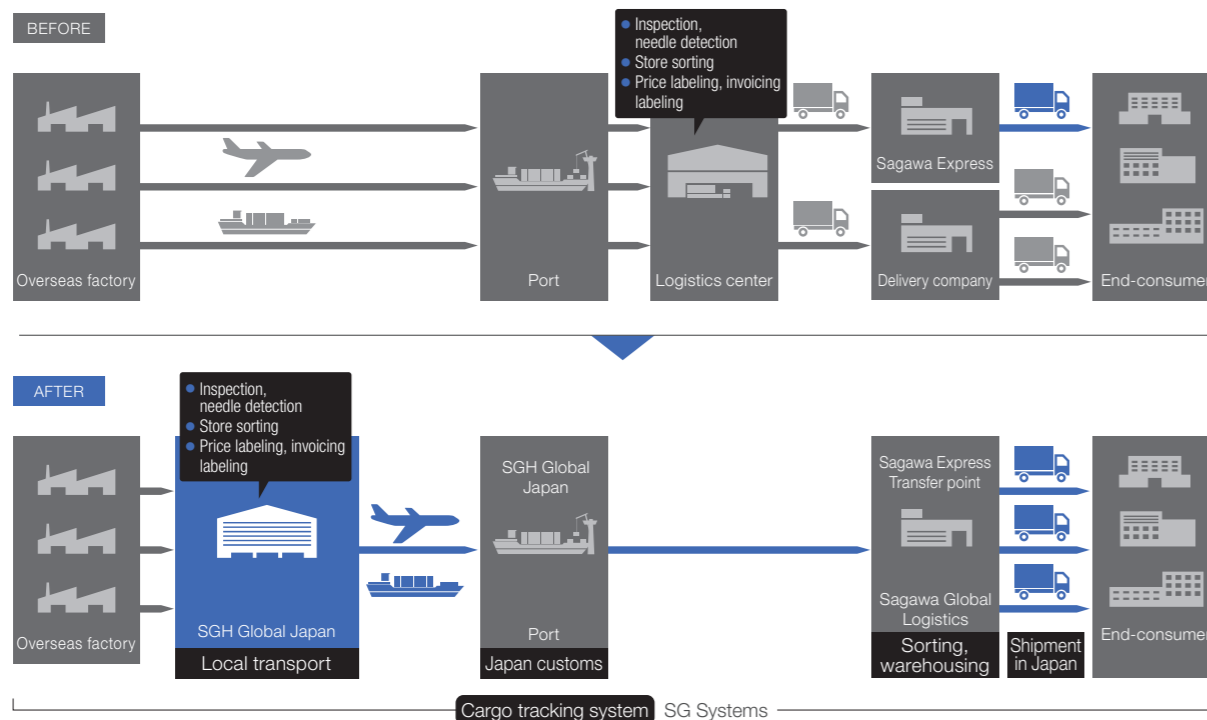

Solution benefits

- Cost optimization
- Lead time reduction
- Combinable with other Group services

Ideal for:

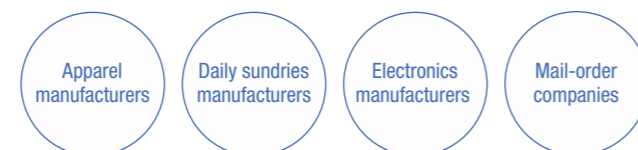

Facility logistics



Facility logistics systems ensure an efficient flow of people, goods, vehicles, and information by integrating logistics management at large-scale multipurpose facilities.

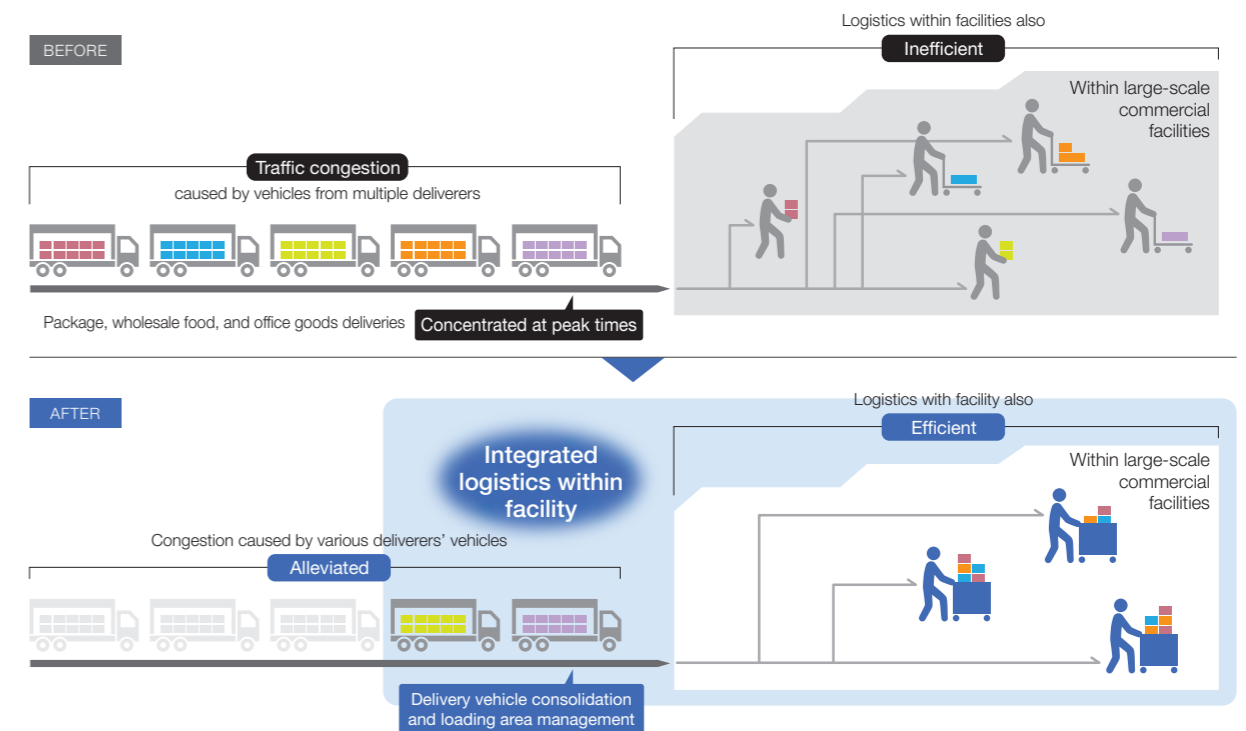

Solution benefits

- Delivery vehicle congestion alleviated
- Secure, efficient delivery to facility tenants
- Improved security through facility access management
- Reduced CO₂ emissions in local areas, reduced environmental burden

Ideal for:



SG Holdings Group By the Numbers

Global network

38 countries and regions
154 companies



External network

Line-haul transportation partner companies:

approximately **310**

Delivery supporters:

approximately **3,410**

TMS partner companies:

approximately **1,630**

Employees

93,403

Total number of employees of all Group companies

- Average age **42.0**
- Regular employees **53.5%**
Other types of employees **46.5%**
- Delivery employees **73,749**
- Non-Japanese employees **8,517**

Ratio of female employees **32.6%**

Female 30,449 Male 62,954

Number of vehicles

27,115

Total number of vehicles owned by all Group companies



Operation sites

1,463

Total number of sites including head offices, offices, sales sites, etc.



Number of packages handled (in Japan)

1.373 billion

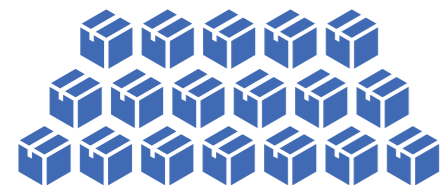

Cumulative number of packages handled by SG Holdings Group's main delivery services in FY2023

Area of company-owned forests

862.59 ha
(183 times the area of Tokyo Dome)

Total land area of forests owned by Group companies Sagawa Forestry and Sagawa Express in Kochi Prefecture, Tokushima Prefecture, and the Tokyo metropolitan area.



All figures are as of March 31, 2024 unless otherwise stated.

Financial and Operating Results

Operating revenue

In the Delivery Business, the number of packages decreased in both BtoB and BtoC due to changes in the external environment. In the Logistics Business, the volume of ocean and air cargo continued to decrease.

As a result, operating revenue decreased 8.2% from the previous fiscal year to 1,316.940 billion yen.

8.2% ↓
1,316.940 billion yen.

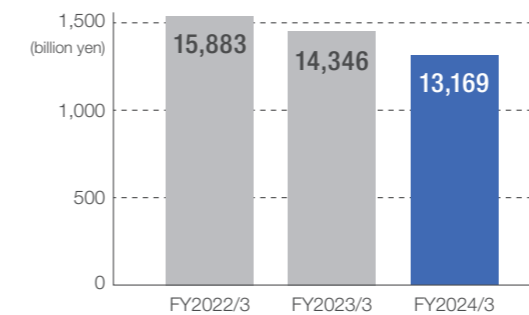

Operating income and operating margin

Operating income decreased by 34.1% from the previous fiscal year to 89.2 billion yen due to a decrease in operating revenue and an increase in personnel, outsourcing, and other costs associated with inflation. The operating margin also decreased by 2.6 points from the previous fiscal year to 6.8%.

34.1% ↓ **89.2** billion yen
2.6 points ↓ **6.8%**

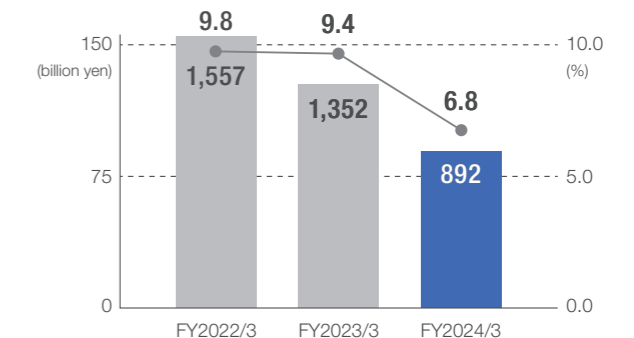

ROE

ROE decreased 0.2 points from the end of the previous fiscal year to 10.3%.

13.8 points ↓ **10.3%**

Dividend payout ratio and EPS

The year-end dividend was 25.0 yen per share, for a dividend payout ratio of 54.9%. EPS was 92.98 yen per share.

54.9% **92.98** yen

R O E : Return on equity
E P S : Earnings per share

All figures are from FY2024/3 results.

CSR Activities

We fulfill our corporate social responsibilities through a diverse program of activities.

Safety and quality initiatives

We make safety and security our No. 1 priority in our role as an organ of society entrusted with the logistics function of the social infrastructure.



Driver education and training systems

We provide drivers with regular safety training, both when they enter the company and throughout their careers, to reduce traffic accidents and ensure safe driving at all times.

Diversity initiatives

We aim to be an organization where a diverse range of talent can thrive, no matter their gender, age, or nationality.



Promotion of active roles for female employees

We aim for a system whereby female employees generate 30% of Group revenues. We have established a system to support women's empowerment, such as implementing "Women's Career Support Training" for supporting career development.

Environmental initiatives

We are promoting environmentally conscious activities for the Earth as a logistics company operating vehicles in its business.



Low-emissions vehicles

We are introducing hybrid, electric, and natural gas and other low-emissions trucks in order to reduce CO₂ emissions from transportation and delivery.



Conserving bountiful forests for the future

We continually maintain the forests we own in the Shikoku region of Japan, as a way to contribute to the public functions of the forest, such as helping to absorb CO₂, conserve the soil, cultivate clean water sources, and promote biodiversity.

Other activities

SGH Foundation



Scholarships for exchange students

We provide scholarships to private-paying Southeast Asian students studying in Japan as a way to promote international exchanges and friendship between Japan and Southeast Asia.



Cancer research support

We provide financial support for basic and clinical cancer research, as well as for cancer nursing research, as a way to improve medical welfare.



International economic cooperation

We accept international trainees and offer intensive training courses on logistics in order to develop logistics personnel and promote the growth of developing Asian nations.

SGH Culture and Sports Promotion Foundation Sagawa Art Museum



Image of Sagawa Art Museum located alongside Lake Biwa

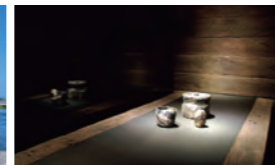

Image of Kichizaemon Raku Pavilion

The museum opened in March 1998 with the goal of promoting arts and culture. Separate pavilions are dedicated to Ikuo Hirayama, Churyo Sato, and Kichizaemon Raku, representing the fifteenth generation of ceramics masters. Each pavilion has separate themes and holds special exhibits.

Official sports clubs

SG Holdings Track and Field Club

SG Holdings Women's Softball Club

Sites Outside Japan

SG Holdings Group has operations in 38 countries and regions around the world.

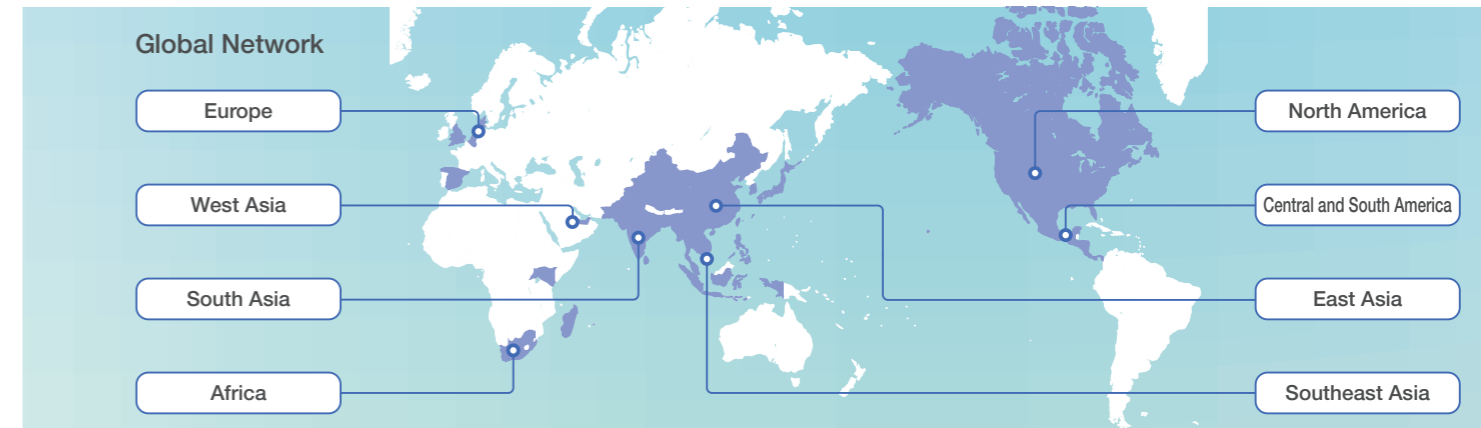

List of Overseas Group Companies

East Asia

China
Shanghai Runbow Logistics & Technology Co., Ltd.
Shanghai Sagawa HongMai Logistics Co., Ltd.
Beijing Runbow Wuyuan Logistics LLP
Shenyang Runbow Supply Chain Technology Co., Ltd.
Shanghai Jiangping Chemical Products Transportation Co., Ltd.
Shanghai Runbow Industrial Co., Ltd.
Shanghai Runbow Logistics Co., Ltd.
Tianjin Hongdi Supply Chain Management Co., Ltd.
Inner Mongolia Hongtie Multimodal Transport Logistics Co., Ltd.
Shanghai New Wonder Software Co., Ltd.
Shanghai Hongxizhao Environmental Protection Technology Co., Ltd.
Kunshan Runbow Supply Chain Technology Co., Ltd.
Guodian Golmud Photovoltaic Power Generation Co., Ltd.
Sagawa Express International Logistics (Shanghai) Co., Ltd.
Sagawa Express International Logistics (Shenzhen) Co., Ltd.
Expo Freight (Shanghai) Limited
Expofreight (Shenzhen) Limited
Wuxi Feisu Logistics Information Technology Co., Ltd.

Hong Kong
Sagawa Express (H.K.) Co., Ltd.
Expofreight (Hong Kong) Ltd

Korea
SAGAWA LOGISTICS KOREA CO., LTD.

Taiwan
HCT Sagawa Express Co., Ltd.
EFL Taiwan (Pvt) Ltd

Southeast Asia

Cambodia
Expolanaka Freight (Cambodia) Ltd
EAM Global (Pvt) Co., Ltd.

Indonesia
PT. EFL Global Indonesia
PT Oki Doki Indonesia

Laos
SG SAGAWA (THAILAND) CO., LTD. VIENTIANE BRANCH

Malaysia
EFL Malaysia Sdn. Bhd

Myanmar
EXPO Freight Limited

Philippines
SAGAWA EXPRESS PHILIPPINES INC.
SAGAWA GLOBAL LOGISTICS (PHILIPPINES) INC.
Expolanaka Freight (Philippines) Inc.

Singapore
SG SAGAWA AMERIOD PTE. LTD.
EFL Global Logistics (Pte) Ltd
AMGAS ASIA PTE. LTD.
SG HOLDINGS GLOBAL PTE. LTD.
Logistics Park Global (Pte.) Ltd
EFL Vietnam Global (Pte.) Ltd
Oki Doki Global (Pte.) Ltd
Peri Logistics Global (Pte) Ltd

Thailand
SG SAGAWA (THAILAND) CO., LTD.
SAGAWA EXPRESS (THAILAND) CO., LTD
Expo Freight Holdings (Thailand) Limited
EFL Global (Thailand) Ltd

Vietnam
SAGAWA EXPRESS VIETNAM CO., LTD.
SG SAGAWA VIETNAM CO., LTD.
Expolanaka Freight (Vietnam) Ltd
SG MOTORS VIETNAM Co., Ltd.
MEITO VIETNAM CO., LTD.
T&M TRANSPORTATION CO., LTD.

South Asia and West Asia

Bangladesh
Travel Classic (Pvt) Limited
EFL Global Limited
Logistics Park Global Bangladesh (Pvt) Ltd.

India
Expo Freight Private Limited
TT Aviation Handling Services (Private) Limited
EFL Express Private Limited
AVS Cargo Management Services Pvt Ltd
AMZ Logistics Solutions Private Limited
EFL Global Projects Private Limited
International Sky Services India Pvt Ltd
EFL Logistics Park India Private Limited
Expolanaka Agri Exports (Private) Limited

Republic of Maldives
Amana Takaful Maldives PLC

Sri Lanka
EXPOLANKA HOLDINGS Limited*
Liberty Tourism Lanka (Pvt) Ltd
Expolanaka (Pvt) Limited
Tropikal Life International (Pvt) Ltd
ITX 360 (Pvt) Ltd
Classic Travel (Pvt) Ltd
Sunpower Travels (Pvt) Ltd
Bongo (Pvt) Ltd
Travel Bridge (Pvt) Ltd
Classic Destinations (Pvt) Ltd
Gabo Travels Overseas (Private) Limited
Gabo Travels (Pvt) Ltd
Gabo Holidays (Private) Limited
Expo Visa Services (Pvt) Ltd
Expolanaka Freight (Pvt) Limited
Oki Doki (Pvt) Ltd
Quickies Delivery Solutions (Pvt) Limited
Peri Logistics (Pvt) Ltd
EFL Transport (Pvt) Ltd
Logistics Park (Pvt) Ltd
Mirai Logistics (Pvt) Ltd
SG Logistics (Pvt) Ltd
EFL Global HQ (Pvt) Ltd
EFL Global Freeport (Pvt) Ltd
EFL Hub (Pvt) Ltd
Excelsior Logistics (Pvt) Ltd
Freightcare (Pvt) Ltd
Globe Air (Pvt) Ltd
International Airline Service (Pvt) Ltd
Alpha Aviation Pvt Ltd
Alpha Air Solutions Pvt Ltd
EAM Global (Pvt) Ltd
AVS Cargo International (Pvt) Ltd

United Arab Emirates
Expolanaka Freight FZCO
Airline Cargo Resources FZCO
Classic Trip Tourism LLC
ITX Global DMCC
Expolanaka Freight Dubai LLC
Tropikal Global L.L.C-FZ

Europe

Belgium
EFL Global B.V.

Denmark
EFL Global Aps

England & Wales
EFL Global UK (Pvt) Ltd

*The company name has been changed to the one stated as of October 14, 2024

Netherlands
EFL Europe B. V.

Spain
EFL Global Spain, S.L.

North America

Canada
Locher Evers International Inc
LEI Cartage Ltd.
Westcon Terminals Limited
Trans American Customs Brokers of Canada Ltd
EFL Global Logistics Canada Ltd

United States of America
SG SAGAWA USA INC.
EFL Global LLC
Trans American Customhouse Brokers LLC
Trans American Global Trade Services LLC
Transure Express LLC
Transparency Supply Chain Systems LLC
Information Technology-Intelligent Solutions LLC
EFL Container Lines LLC
EFL Transportation LLC
Seville Freight Systems Inc
Seville Transfer Ltd
EFL Brokerage LLC
Seville Container Freight Station Inc
IDEA Global LLC
IDEA International LLC
Interconexión: Distribuir Y Enviar Para Las Americas, LLC d/b/a IDEA, LLC
Complete Transport Systems LLC

Central and South America

Costa Rica
EFL Global Costa Rica S. A.

El Salvador
EFL Global El Salvador S.A. de C.V.
Corporación K&C, S.A. de C.V

Guatemala
IDEA Guatemala S.A

Honduras
IDEA Honduras, S. de R.L. de C.V

Mexico
EFL Global Mexico

Nicaragua
IDEA Nicaragua de S.A

Panama
EFL Global Panama S.A.

Africa

Kenya
Air Sea Logistics Limited
Expolanaka Freight Ltd
Ceylon Cargo Management Limited
Expolanaka Global SEZ Limited

Madagascar
Expolanaka Madagascar

Mauritius
Expolanaka Freight Ltd.

Republic of South Africa
Expolanaka Freight (Proprietary) Ltd

Uganda
EFL Global Freight - SMC Ltd

Current as of September 30, 2024

Corporate Overview

Company Name: SG Holdings Co., Ltd.

Establishment: March 2006

Capital: 11,882,905,000 yen

Business Content: Formulation of Group management strategies, administration, and related business

Head Office: 68 Kamitobatsunoda-cho, Minami-ku, Kyoto-shi, Kyoto, Japan
Tel: 075-671-8600 Fax: 075-671-8607

Officers:

- Eiichi Kuriwada, Chairperson and CEO
- Hidekazu Matsumoto, President and COO
- Masahide Motomura, Director in charge of Delivery and Logistics Business
- Katsuhiro Kawanago, Director in charge of Corporate Planning
- Kimiaki Sasamori, Director in charge of Special Assignment
- Mika Takaoka, Outside Director
- Osami Sagisaka, Outside Director
- Masato Akiyama, Outside Director
- Satoshi Tajima, Outside Audit & Supervisory Board Member
- Tomonari Niimoto, Audit & Supervisory Board Member
- Kenichiro Okamura, Outside Audit & Supervisory Board Member
- Yoshitaka Ooshima, Outside Audit & Supervisory Board Member

Employees: 93,403 (consolidated; as of March 31, 2024)

Corporate History

1965	November	Sagawa Express is established.	2009	February	All shares in World Supply Co., Ltd. are acquired from World Logi Co., Ltd. to make the company a subsidiary.
1975	July	Kyoto Automobile Kogyo (current Sagawa Advance Services Co., Ltd.) is established.	2011	April	SG Expert Co., Ltd. is established. (Became defunct in October 2021 through the absorption-type merger with SG Systems Co., Ltd. as the surviving company.)
1980	May	Sagawa Automobile Company (current SG Motors Co., Ltd.) is established.		April	SG Fielder Co., Ltd. is established.
	September	Sagawa Air Service Co., Ltd. (current SGH Global Japan Co., Ltd.) is established.	2012	June	SG Holdings Global Pte. Ltd. is established.
1983	February	Sagawa Computer System (current SG Systems Co., Ltd.) is established.	2013	April	SG Assetmax Co., Ltd. is established.
1984	December	Sagawa Express nationwide longitudinal route network is completed.		May	Sagawa Global Logistics Co., Ltd. changes its name to SGH Global Japan Co., Ltd. and implements a company split to newly establish Sagawa Global Logistics Co., Ltd. to succeed the domestic logistics business.
1985	January	Sagawa Express National Freight Tracking System is launched.		May	SG Holdings acquires Singapore logistics company Ameroid Logistics (S) Pte. Ltd. (current SG Sagawa Ameroid Pte. Ltd.) to strengthen the Singapore logistics business.
1988	October	Tsubasa Transport (current SG Moving Co., Ltd.) becomes a subsidiary.		November	SG Sagawa USA, Inc. is established to provide high-quality integrated services leveraging the Group's extensive network in Japan.
1990	August	Sagawa Express (H.K.) Co., Ltd. is established.	2014	April	Sagawa Express establishes "GOAL", a Group-wide strategic sales development team.
	December	Sagawa Forestry Co., Ltd. is established.		June	SG Holdings Global acquires Sri Lanka logistics company Expolanka Holdings Limited with the aim of expanding the international cargo business.
1997	June	Sagawa Express Vietnam Co., Ltd. is established.	2015	March	SG Sagawa Vietnam Co., Ltd. is established to provide cargo and logistics services in Vietnam.
	August	Sagawa Express Philippines Co., Ltd. is established.	2016	March	SG Holdings enters into strategic capital and business alliance agreement with Hitachi Transport System, Ltd. (current LOGISTEED, Ltd.)
1998	March	Sagawa Express starts door-to-door delivery service Sagawa Express (current Hikyaku Express) service.		November	Phat Loc Express and Trading Joint Stock Company acquired with the aim of expanding and strengthening the Vietnam delivery business and building the customer base (name changed to SG Sagawa Express Vietnam, LLC in March 2017 and later dissolved following absorption-type merger into surviving company SG Sagawa Vietnam Co., Ltd.).
	July	Sagawa Express Singapore Co., Ltd. is established (merged into SG Sagawa Ameroid Pte. Ltd. in 2017)		December	VST Co., Ltd. (current Sagawa Humony Co., Ltd.) becomes a subsidiary with the aim of expanding the telegram-like services business.
1999	March	Sagawa Express starts Hikyaku Cool Express chilled service.	2017	December	SG Holdings is listed on the First Section of the Tokyo Stock Exchange.
	June	Sagawa Express commences online package inquiry service on company homepage.	2019	May	Established SG Motors Vietnam Co., Ltd. for the purpose of supplying vehicle refrigeration equipment in Vietnam.
2000	March	Sagawa Express starts Hikyaku Cool Express frozen service.	2020	March	Acquired Shanghai Runbow Logistics & Technology Co., Ltd. for the purpose of expanding logistics business in East Asia and China.
	March	Sagawa Express starts delivery time selection service.		March	Transited from the First Section of the Tokyo Stock Exchange to the Prime Market of the Tokyo Stock Exchange in accordance with market restructuring.
2001	September	Nouvelle Golf Club is established.	2024	July	Chilled & Frozen Logistics Holdings Co., Ltd. becomes subsidiary for the purpose of expanding cold chain logistics
2003	September	Poly-Sagawa Logistics CO.,Ltd. (current Sagawa Express International Logistics (Shenzhen) Co.,Ltd.) is established.			
2004	June	Shanghai Poly-Sagawa Logistics CO.,Ltd. (current Sagawa Express International Logistics (Shanghai) Co.,Ltd.) is established.			
	June	Tianjin Poly-Sagawa International Trading Co., Ltd. is established.			
2005	January	Sagawa Express Korea (current Sagawa Logistics Korea Co., Ltd.) is established.			
	March	Sagawa Financial is established. (Became defunct in October 2021 through the absorption-type merger with SG Systems Co., Ltd. as the surviving company.)			
	September	Sagawa Express International Taiwan Corp. is established.			
2006	March	Pure holding company structure is adopted and SG Holdings Co., Ltd. is established.			
2006	June	SG Holdings Co., Ltd. acquires shares in Sagawa Global Logistics Co., Ltd. (current SGH Global Co., Ltd.) and 10 other companies.			
2007	August	SG Realty Co., Ltd. is established.			